

**SULO<sup>®</sup>**

**240 LITRE KSB CONTAINER**



**DESIGNED FOR THE AUSTRALIAN MARKET**



## DRIVEN BY INNOVATION

The introduction of traditional Mobile Garbage Bins (MGBs) changed the way the world collected garbage. The world, however, has since evolved and no longer collects garbage but instead recovers resources. The SULO 240L KSB offers all the traditional advantages of an MGB system but with improved operational safety and reliability for today's collection services.

Modern collection vehicles place stress on collection containers as a result of the acceleration forces produced during lifting, which are significantly higher on side loader vehicles commonly used in Australia. The strain on a collection container is enormous. The SULO 240L KSB incorporates a unique column structure that disperses the stress whilst allowing the container to flex.

The SULO 240L KSB is manufactured in accordance with the Australian Standard AS4123 and the European Standard EN 840, ensuring the highest quality standards are maintained across the SULO range. It is designed to work in with existing infrastructure, allowing it to be phased into any fleet, and is compatible with standard SULO components.

KSB represents the merging of our Australian innovation with our German heritage, it brings our history into the future.



- K** Klammeraufnahme : Grabber
- S** Säulenstruktur : Column Structure
- B** Behälter : Bin

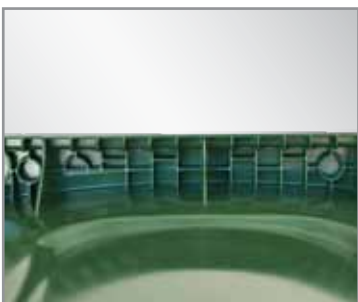



## DESIGNED FOR THE LOCAL MARKET

The SULO 240L KSB was designed by Australians for Australians, the new innovative shape was specifically created to suit the local market. Its unique column structure disperses the stress placed on a bin during lifting which is the result of acceleration forces initiated by the lifting mechanism on collection vehicles, in particular side loaders.

The ergonomic design of the KSB incorporates large easy grip handles, unique hand grips and a rear footstep for easy handling. The modern footprint and external position of the wheels, as well as the steel axle, ensure maximum stability at all times. The SULO 240L KSB was designed with not only the collector in mind but also the end user.

## IMPROVED DESIGN FEATURES

- Unique Australian design with a specialised lifting structure
- Footstep at rear assists in tilting the bin especially with heavy loads
- Large easy grip rear handles for maximum comfort
- Ribbed side hand grips for easy handling
- Designated lifting zone for instant driver recognition

## INCREASED SAFETY

- Specialised lifting columns disperse stress during lifting
- Dual axle housing provides maximum strength
- Textured finish on side lifting columns for improved grip during lifting
- Compatible with all standard vehicles and lifting devices
- Modern footprint provides improved stability

## ACCESSORIES

A comprehensive range of accessories are available for the 240L KSB making a customised solution for any application a reality.

SULO's standard accessories include various recycling apertures, manual and gravity lid locks, bin stands and the application of customer specific markings including the latest unique laser identification and multi colour lid print.

*Minimum order quantities and setup up charges may apply.*



# DELIVERING VALUE THROUGH INTEGRATED SOLUTIONS

SULO's strength lies in decades of experience in waste management. As Australia's largest manufacturer of waste containment solutions SULO has developed a network of distributors, a team of account managers and customer service support together with a dedicated research and development centre that incorporates a NATA (National Association of Testing Authority) accredited laboratory.

In addition to our comprehensive range of products, SULO offers a range of service solutions including financing, assembly and distribution, fleet maintenance and recycling of old containers.

## Colours



## Quality

- Certified to AS4123 and EN840

## Dimensions and Weights

- Nominal volume: 240 litres
- Net weight: approx 12.5 kg
- Max load: 96 kg
- Permitted total weight: 110 kg (incl. bin)

- A 1060mm
- B 990mm
- C 660mm
- D 730mm
- E 585mm
- F 400mm
- G 550mm

Measurements to be used as a guide only – variations will occur

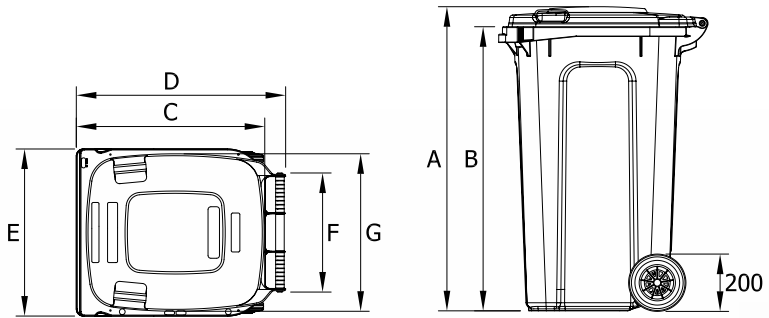

**SULO MGB Australia Pty Ltd**  
123 Wisemans Ferry Road  
Somersby NSW 2250  
Australia  
Tel: +61 (0) 2 - 4348 8188  
Fax: +61 (0) 2 - 4348 8128  
[www.sulo.com.au](http://www.sulo.com.au)  
[info@sulo.com.au](mailto:info@sulo.com.au)

**SULO – Queensland Office**  
11 Argon Street  
Sumner Park QLD 4074  
Australia  
Tel: +61 (0) 7 - 3725 5000  
Fax: +61 (0) 7 - 3725 5099

**SULO – Victorian Office**  
1950 Hume Hwy  
Campbellfield VIC 3061  
Australia  
Tel: +61 (0) 3 - 9357 7320  
Fax: +61 (0) 3 - 9357 7340

**SULO Talbot - New Zealand**  
Gate 4, 13 Kenwyn Avenue  
East Tamaki, Manukau City 2013  
New Zealand  
Tel: +64 9 - 968 2180  
Fax: +64 9 - 968 2188  
[www.sulo-talbot.co.nz](http://www.sulo-talbot.co.nz)  
[info@sulo-talbot.co.nz](mailto:info@sulo-talbot.co.nz)

**SULO®**  
ENVIRONMENTAL TECHNOLOGY

© 2012 Subject to technical amendments.