

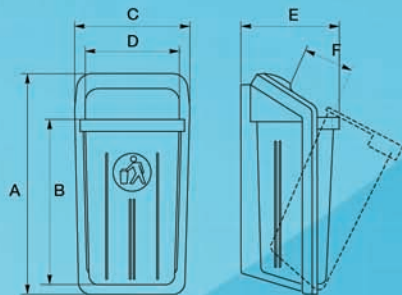

mörbel<sup>®</sup>  
urban containers



# Galaxy



The Galaxy litter bin incorporates smooth internal and external surfaces for easy cleaning and drainage holes in the body that allow rainwater to drain.

With a wide lid that allows easy access, yet is designed to prevent strong winds from dispersing the waste, the Galaxy litter bin is ideal for use in any urban setting be it indoor or outdoor containerisation.

## STANDARD MATERIALS

### Material

- UV Stabilised HDPE
- Injection moulded

### Colour

- Standard colour: Dark Grey (Stand and Body)
- Non standard colours available on request

## QUALITY ASSURANCE

- Manufactured on an ISO9001 and ISO14001 certified site in Europe

## STANDARD SPECIFICATIONS

### Dimensions

A	845
B	640
C	460
D	375
E	390
F	200

all measurements in mm and are to be used as a guide only.  
Variations may occur.

### Capacity

- 50 litres

### Lock

- 8mm triangle

### Fixing

- Wall or post mounting

## ADDITIONAL OPTIONS

- Logo moulding or vinyl stickers