

140 LITRE KOMPAKT CONTAINER: SIMPLY A BETTER BIN



EASY HANDLING
VERSATILE
STABLE DESIGN

Designed for local market

- Manufactured in accordance with AS4123
- Stable on uneven surfaces and against wind
- Larger footprint increases stability
- Lower centre of gravity



Multiple applications

- Part of a multi-bin system
- Assists with waste reduction goals but with the look of a larger container
- Ideal for homes, multi-unit dwellings and offices



Improved design features

- Larger opening and body
- Non-impact lid that reduces noise
- Internal concave floor assists emptying



140 LITRE CONTAINER

Material

- **Polymer components:**
 - Injection moulded from specially designed HDPE
 - Resistant to decay, frost, heat and chemicals
 - Special UV-stabilisation provides excellent ageing characteristics
- **Corrosion resistant steel axle**
- **Noise reduction:**
 - Quiet-running solid rubber tyres
 - Tight-fitting axle
- **Long service life:**
 - High quality materials
 - Most advanced manufacturing processes
 - Withstands exposure to high mechanical stress levels
- **Recycling:**
 - All container parts are recyclable

Advantages

- Easy to manoeuvre
- Versatile, with a comprehensive accessories range
- Complies with EN840 and AS4123 quality requirements
- Particularly stable due to external position of wheels
- Safe and easy to handle
- Suitable for all DIN lifting equipment
- Double angle rail for greater safety when emptying
- Compatible with identification and weighing systems
- Special ribs prevent containers from becoming jammed when stacked

Imprints and markings

- Manufacturer, year of manufacture, material
- Nominal volume, max permitted total weight
- EN 840 and AS4123 markings
- Individual markings with imprints, hot-foil printing or adhesive labels*
- Customer specific serial numbers if required*

Accessories

- For accessories and special design variations such as lid apertures and locks please refer to the separate accessories sheet for 2-wheeled containers



SULO MGB Australia Pty Ltd
123 Wisemans Ferry Road
Somersby NSW 2250
Australia
Tel: +61 (0) 2 - 4348 8188
Fax: +61 (0) 2 - 4348 8128
Internet: www.sulo.com.au
E-mail: info@sulo.com.au

SULO – Queensland Office
11 Argon Street
Sumner Park QLD 4074
Australia
Tel: +61 (0) 7 - 3725 5000
Fax: +61 (0) 7 - 3725 5099

Quality

- Certified according to EN840
- Manufactured in accordance with AS4123

Dimensions - Weights - Standards

- Nominal volume: 140 litres
- Net weight: approx 10.4 kg
- Max load: 56 kg
- Permitted total weight: 70 kg

- | | | | | | |
|-----|--------|-----|--------|-----|--------|
| ■ A | 915 mm | ■ D | 615 mm | ■ G | 505 mm |
| ■ B | 870 mm | ■ E | 535 mm | | |
| ■ C | 550 mm | ■ F | 395 mm | | |

Measurements to be used as a guide only – variations will occur

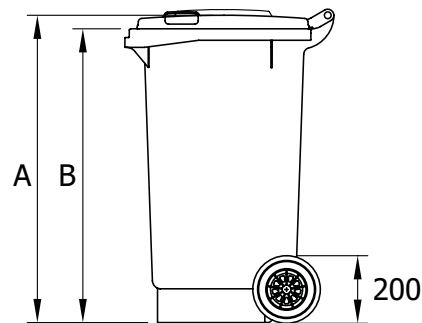
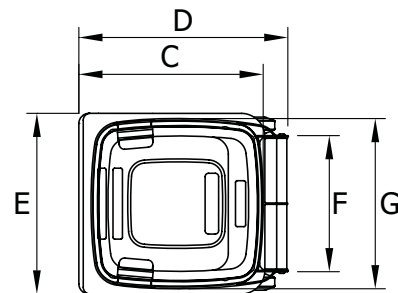

Colours

- Standard colours: black, nature green, dark green, grey
- Special colours are available on request* – common colours include blue, yellow, red, orange



SULO – Victorian Office
1950 Hume Hwy
Campbellfield VIC 3061
Australia
Tel: +61 (0) 3 - 9357 7320
Fax: +61 (0) 3 - 9357 7340

SULO - New Zealand
PO Box 58 962
Greenmount, Manukau City 2141
New Zealand
Tel: +64 9 - 968 2180
Fax: +64 9 - 968 2188